

LM CLOSED LINEAR BUSHING

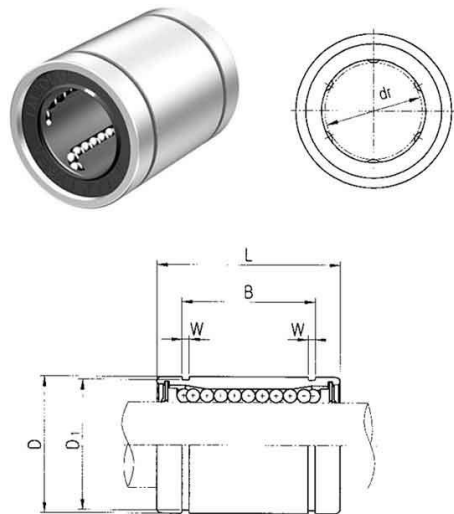

Samick Linear Bushing	LM	20	UU	-	A	N	S
Nominal Shaft Diameter							
Seal	Blank : No Seal U : One Side Seal UU : Both Side Seal						
Retainer	Blank : Resin retainer(Standard) A : Steel retainer(High temperature)						
Outer-sleeves (by corrosion resistance type)	Blank : No-plating(Standard) N : Electroless nickel plating R : Raydent treatment						
Ball type (by corrosion resistance)	Blank : High carbon bearing steel ball (standard) S : Stainless steel ball						

PART NUMBER		DIAMETER		OUTER DIAMETER		L	B	W	D ₁	BASIC LOAD RATING(N)		NO. OF BALL CIRCUIT	WEIGHT (gf)
Resin	Steel	dr.	TOLERANCE	D	TOLERANCE					DYNAMIC(C)	STATIC(C ₀)		
LM5	LM5-A	5	0 -0.008	10	0 -0.008	15	10.2	1.1	9.6	167	206	4	4
LM6	LM6-A	6	0 -0.008	12	0 -0.011	19	13.5	1.1	11.5	200	260	4	8
LM8S	LM8S-A	8		15		17	11.5	1.1	14.3	170	220	4	11
LM8	LM8-A	8	0 -0.009	15	0 -0.013	24	17.5	1.1	14.3	260	400	4	16
LM10	LM10-A	10		19		29	22.0	1.3	18	370	540	4	30
LM12	LM12-A	12	0 -0.010	21	0 -0.016	30	23.0	1.3	20	410	590	4	31.5
LM13	LM13-A	13		23		32	23.0	1.3	22	500	770	4	43
LM16	LM16-A	16	0 -0.012	28	0 -0.019	37	26.5	1.6	27	770	1170	5	69
LM20	LM20-A	20		32		42	30.5	1.6	30.5	860	1370	5	87
LM25	LM25-A	25	0 -0.015	40	0 -0.022	59	41.0	1.85	38	980	1560	6	220
LM30		30		45		64	44.5	1.85	43	1560	2740	6	250
LM35		35	0 -0.012	52	0 -0.019	70	49.5	2.1	49	1660	3130	6	390
LM40		40		60		80	60.5	2.1	57	2150	4010	6	585
LM50		50	0 -0.015	80	0 -0.022	100	74.0	2.6	76.5	3820	7930	6	1580
LM60		60		90		110	85.0	3.15	86.5	4700	9990	6	2000

Note 1) Dynamic load rating is based on the nominal life of 50km.

In case of 100km, C on the table need to be divided by 1.26

Ex) LM12's 50km basis dynamic load rating C = 410N

LM12's 100km basis dynamic load rating $C_{100} = 410 / 1.26 = 325,40N$

Note 2) Based on the weight of resin retainer

Note 3) Dimension : mm

LM_L LONG LINEAR BUSHING

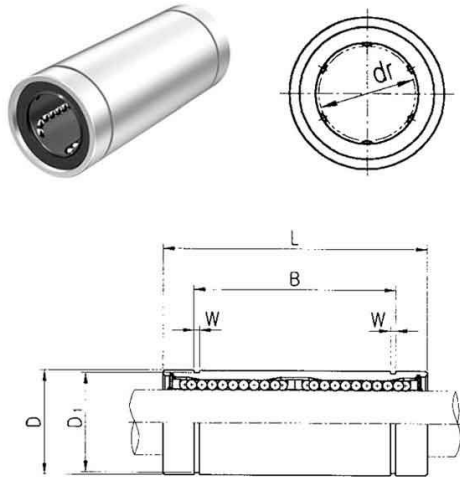

Samick Linear Bushing	LM	20	L	UU	-	A	N	S
Nominal Shaft Diameter								
Linear Bushing Long type (for high load)								
Seal	Blank : No Seal U : One Side Seal UU : Both Side Seal							
Retainer	Blank : Resin retainer(Standard) A : Steel retainer(High temperature)							
Outer-sleeves (by corrosion resistance type)	Blank : No-plating(Standard) N : Electroless nickel plating R : Raydent treatment							
Ball type (by corrosion resistance)	Blank : High carbon bearing steel ball (standard) S : Stainless steel ball							

PART NUMBER		DIAMETER		OUTER DIAMETER		L	B	W	D ₁	BASIC LOAD RATING(N)		NO. OF BALL	WEIGHT (gf)
Resin	Steel	d _r	TOLERANCE	D	TOLERANCE					DYNAMIC(C)	STATIC(C ₀)		
LM6L	LM6L-A	6		12	⁰	35	27	1.1	11.5	320	520	4	16
LM8L	LM8L-A	8		15	⁰ _{-0.013}	45	35	1.1	14.3	430	780	4	31
LM10L	LM10L-A	10		19	⁰ _{-0.010}	55	44	1.3	18	580	1100	4	62
LM12L	LM12L-A	12		21	⁰ _{-0.016}	57	46	1.3	20	650	1200	4	80
LM13L	LM13L-A	13		23	⁰ _{-0.016}	61	46	1.3	22	810	1570	4	90
LM16L	LM16L-A	16		28	⁰ _{-0.016}	70	53	1.6	27	1230	2350	5	145
LM20L	LM20L-A	20		32	⁰ _{-0.019}	80	61	1.6	30.5	1400	2750	5	180
LM25L	LM25L-A	25	⁰ _{-0.012}	40	⁰ _{-0.019}	112	82	1.85	38	1560	3140	6	440
LM30L		30		45	⁰ _{-0.019}	123	89	1.85	43	2490	5490	6	580
LM35L		35		52	⁰ _{-0.019}	135	99	2.1	49	2650	6470	6	795
LM40L		40	⁰ _{-0.015}	60	⁰ _{-0.022}	154	121	2.1	57	3430	8040	6	1170
LM50L		50		80	⁰ _{-0.022}	192	148	2.6	76.5	6080	15900	6	3100
LM60L		60	⁰ _{-0.020}	90	⁰ _{-0.025}	211	170	3.15	86.5	7650	20000	6	3500

Note 1) Dynamic load rating is based on the nominal life of 50km.
 In case of 100km, C on the table need to be divided by 1.26
 Ex) LM12 s 50km basis dynamic load rating C = 410N
 LM12 s 100km basis dynamic load rating C₁₀₀ = 410 / 1.26 = 325.40N

Note 2) Based on the weight of resin retainer
 Note 3) Dimension : mm

| LM_OP OPEN LINEAR BUSHING |

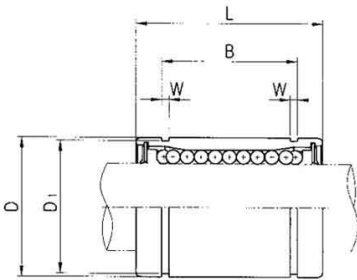
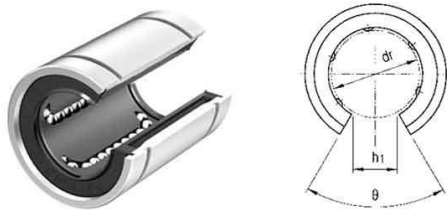

Samick Linear Bushing	LM	20	UU	OP	-	A	N	S
Nominal Shaft Diameter								
Seal								
Blank : No Seal U : One Side Seal UU : Both Side Seal								
Linear Bushing Open type								
Retainer								
Blank : Resin retainer(Standard) A : Steel retainer(High temperature)								
Outer-sleeves								
(by corrosion resistance type)								
Blank : No-plating(Standard) N : Electroless nickel plating R : Raydent treatment								
Ball type								
(by corrosion resistance)								
Blank : High carbon bearing steel ball (standard) S : Stainless steel ball								

PART NUMBER		DIAMETER		D	L	B	W	h ₁	θ	BASIC LOAD RATING(N)		NO. OF BALL	WEIGHT (gf)
Resin	Steel	dr.	TOLERANCE							TOLERANCE	DYNAMIC(C)		
LM12	OP	12		21	30	23.0	1.3	8	80	410	590	3	31.5
LM13	OP	13	0 -0.009	23	32	23.0	1.3	9	80	500	770	3	43
LM16	OP	16		28	37	26.5	1.6	11	80	770	1170	4	69
LM20	OP	20		32	42	30.5	1.6	11	60	860	1370	4	87
LM25	OP	25	0 -0.010	40	59	41.0	1.85	12	50	980	1560	5	220
LM30	OP	30		45	64	44.5	1.85	15	50	1560	2740	5	250
LM35	OP	35		52	70	49.5	2.1	17	50	1660	3130	5	390
LM40	OP	40	0 -0.012	60	80	60.5	2.1	20	50	2150	4010	5	585
LM50	OP	50		80	100	74.0	2.6	25	50	3820	7930	5	1580
LM60	OP	60	0 -0.015	90	110	85.0	3.15	30	50	4700	9990	5	2000

- Note 1) Dynamic load rating is based on the nominal life of 50km.
In case of 100km, C on the table need to be divided by 1.26
Ex) LM12 s 50km basis dynamic load rating C = 410N
LM12 s 100km basis dynamic load rating C₁₀₀ = 410 / 1.26 = 325.40N
- Note 2) Based on the weight of resin retainer
- Note 3) Dimension : mm
- Note 4) Outer diameter is the obtained value before the slotting process.